

# REDUCTION PRINTS

AMACO®



WITH **NEW** AMACO  
CERAMIC PRINTING INKS

## TOOLS & MATERIALS

- \* AMACO Ceramic Printing Inks
  - AMACO Velvet Underglaze
- \* AMACO LG-10 Clear Transparent Glaze
- \* 2 Low Fire Bisque Tiles
  - 3" Square Thick Craft Foam
- \* Sticky Backed Craft Foam
  - Packing Foam
- \* Brayer
  - Mist Bottle
  - Sharpie Marker
- \* Scissors
  - Cup and Brush
- \* Baby Wipes
  - Tape

# LESSON PLAN OVERVIEW

Use easy-to-find packing material and craft foam to create colorful prints on bisque using AMACO Ceramic Printing Inks. This flexible printing process can also be used on moist clay to make impressions and prints. Discussions will include how Picasso first developed this technique with linocuts.

## STEPS

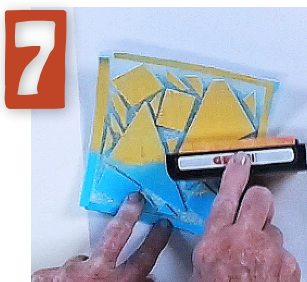
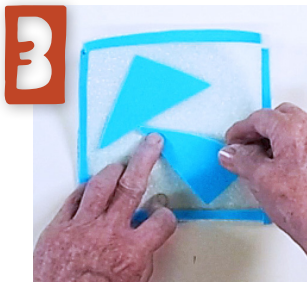
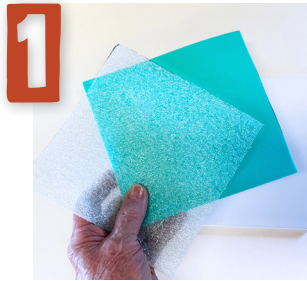

- 1** Cut sticky backed craft foam and packing foam to match the size of the 6" x 6" low fire bisque tile.
- 2** Cut four narrow strips from the sticky back craft foam and press them onto the edges of the packing foam to create a border.
- 3** Cut, peel, and stick two large shapes to the packing foam.
- 4** Cut, peel, and stick five medium sized shapes to the packing foam.
- 5** Cut small shapes to fill the background. The goal is to minimize the amount of negative space.
- 6** Mix a light AMACO Velvet Underglaze about 50/50 with water and liberally apply one coat to the tile.  
[ Suggested colors: V-324 Blush or V-329 Sea Glass ]
- 7** Use a brayer to evenly roll the lightest AMACO Ceramic Printing Ink color onto your custom printing plate.
- 8** Place printing plate face down on tile. Draw an arrow on the back to show the top of the printing plate.
- 9** After pressing firmly on the back of the printing plate, carefully peel it off the tile.
- 10** Remove the smallest shapes, they will remain the lightest color in the final print.





- 11** Ink the printing plate with the medium color, place face down on the tile, and repeat Step 9.
- 12** Remove medium size shapes, they will remain the medium color in the final print.
- 13** Ink the printing plate with the darkest color, place face down on the tile, and repeat Step 9.
- 14** Remove the printing plate, let the ink dry, then apply AMACO LG-10 Clear Transparent Glaze and fire to cone 05.



**TIP:** Use a baby wipe to clean any excess ink that gets on the packing foam.

## GOALS AND OBJECTIVES

**By the end of this lesson, students will be able to:**

1. Understand and explain the reduction printmaking process as it applies to both traditional paper printmaking and ceramic surfaces.
2. Utilize color theory to plan and execute a series of color layers that produce depth and contrast in the final design.
3. Analyze and critique their own work and the work of their peers, discussing the effectiveness of design, use of space, and color choices.

## STOCK UP

Item	Store Type	Keywords
Bisque Tiles	AMACO, Art Supply Distributors and E-Tailers	"bisque tiles" or "ceramic wall tile"
Craft Foam	Art Supply Distributors or Craft Stores	"craft foam" or "foam sheets"
Packing Foam	Hardware Stores and E-Tailers	"packing foam" or "foam wrap"



# HISTORY

Reduction prints were developed by Picasso. This printmaking technique uses a single block which is progressively carved and printed in multiple layers to create a multicolored image.

# GLOSSARY

**Brayer** - a small roller tool used to apply ink evenly onto a printing surface.

**Plate or Printing Plate** - refers to the surface onto which an image is created or transferred for the purpose of making prints.

**Glaze Fire** - To heat glaze materials at a temperature high enough to melt and form a glassy surface coating when cooled.



# PRINCIPLES & ELEMENTS OF DESIGN

**Value** - refers to the lightness or darkness of a color or tone.

**Analogous Colors** - colors located adjacent to each other on the color wheel.



Founding member of the Arts & Creative Materials Institute, Inc. and Council for Art Education.



## DISCOVER MORE!

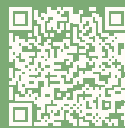

**NEW** AMACO CERAMIC PRINTING INKS



AMACO VELVET UNDERGLAZE



AMACO LOW FIRE GLOSS GLAZES



## NEED MORE LESSON PLANS?

For more lesson plans visit [AMACO.com/lesson\\_plans](https://www.amaco.com/lesson_plans) or scan the QR code.

Part No. 00124G